



SWITCHGEAR

PBD fuse bases

designed for distribution of electricity and protection
of electrical equipment against short-circuits
and overloads with industrial fuse links



CONSTRUCTION&APPLICATIONS

PBD fuse base consist of flame retardant thermoplastic base with spring-loaded contacts designed to be engaged with the blade contacts of NH fuse link. Contacts of sizes 00, 1, 2 are tin plated, contacts of size 3 are silver plated. On request contacts of sizes 00, 1, 2 are plated with silver.

PBD fuse-bases are designed for installation indoors, in environment free of dust, aggressive or explosive gases:

- junction boxes
- supply points
- distribution boards
- capacitor bank protection

OPERATING CONDITIONS

- altitude up to 2000 meters above sea level
- ambient temperature from -25°C to +55°C
- for outdoors installation PBD fuse basess should be mounted in cabinets with protection degree IP34 or higher

CONFORMITY WITH STANDARDS

IEC 60269-1, PN-HD 60269-2:2008, PN-EN 60269-1:2010, Certified with „B" safety mark, Certified with mark „CE":
PBD 2-0031/04, PBD 3-0032/04, PBD 13-0033/04 according to european directive 2006/95/WE; 2006/95/EEC

VERSIONS

- size 00 - 160 A
 - screw terminals for connection of cables with lug terminals or busbars -
 - PBD 00 (1 - pole)
 - PBD 003 (3 - pole)
 - screw terminal and V-shaped terminal
 - PBD 00-1V (1- pole)
 - PBD 003-1V (3 - pole)
 - V-shaped terminals
 - PBD 00-2V (1 - pole)
 - PBD 003-2V (3 - pole)
 - for fuse links of sizes 00 and 000
- size 1 - 250 A
 - screw terminals for connection of cables with lug terminals or busbars -
 - PBD 1 (1 - pole)
 - PBD 13 (3 - pole)
 - screw terminal and V-shaped terminal
 - PBD 1-1V (1- pole)
 - PBD 13-1V (3 - pole)
 - V-shaped terminals
 - PBD 1-2V (1 - pole)
 - PBD 13-2V (3 - pole)
- size 2 - 400 A
 - screw terminals for connection of cables with lug terminals or busbars -
 - PBD 2 (1 - pole)
 - screw terminal and V-shaped terminal
 - PBD 2-1V (1- pole)
 - V-shaped terminals
 - PBD 2-2V (1 - pole)
- size 3 - 630 A
 - screw terminals for connection of cables with lug terminals or busbars -
 - PBD 3 (1 - pole)

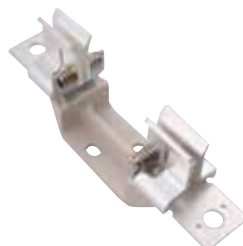
V-shaped terminals with V-terminal clamps enable connection of circular or sector-shaped conductors.



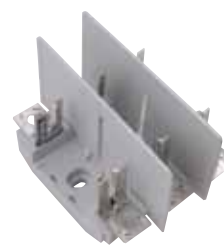
PBD 1-2V



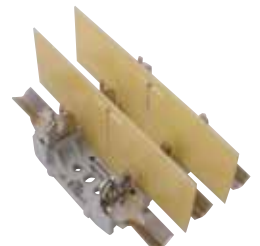
PBD 2-1V



PBD 3

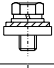
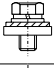


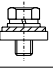
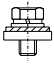

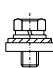
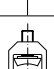
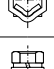
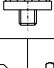


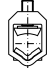
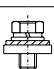
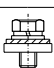
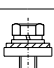


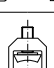
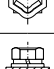

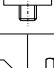


PBD 003 HH



PBD 003 VV

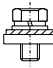

Table 64. PBD FUSE BASES FOR WTNH FUSE LINKS

Article	Size	Rated current I_n	Rated short-circuit withstand current	Cable terminal		Rated power dissipation	Max crosssection of cable conductors	Weight	Article No.
									
PBD 00	00	160 A	25 kA	screw terminals		12 W	70 mm ²	90	1112281070T
PBD00VV	00	160 A	25 kA	V-shaped terminals		12 W	120 mm ²	90	1112281071T
PBD 00-1V	00	160 A	25 kA	Screw terminal, V-shaped terminal	 	12 W	70 mm ² 120 mm ²	90	1112281073T
PBD 1	1	250 A	40 kA	screw terminals		32 W	120 mm ²	370	63-820991-011
PBD 1-1V	1	250 A	40 kA	Screw terminal, V-shaped terminal	 	32 W	120 mm ²	370	63-820991-021
PBD 1-2V	1	250 A	40 kA	V-shaped terminals		32 W	120 mm ²	370	63-820991-031
PBD 2	2	400 A	50 kA	screw terminals		45 W	240 mm ²	520	63-820992-011
PBD 2-1V	2	400 A	50 kA	Screw terminal, V-shaped terminal	 	45 W	240 mm ²	520	63-820992-021
PBD 2-2V	2	400 A	50 kA	V-shaped terminals		45 W	240 mm ²	520	63-820992-031
PBD 3	3	630 A	65 kA	screw terminals		60 W	240 mm ²	810	63-820998-011
PBD 003 HH	00	160 A	25 kA	screw terminals		3 x 12 W	50 mm ²	500	1115 2810 42T
PBD 003 + shroud	00	160 A	25 kA	screw terminals		3 x 12 W	50 mm ²	500	1115 2810 72T
PBD 003 1-V	00	160 A	25 kA	Screw terminal, V-shaped terminal	 	3 x 12 W	50 mm ²	500	1115 2810 80T
PBD 003 VV	00	160 A	25 kA	V-shaped terminals		3 x 12 W	120 mm ²	400	1115 2810 43T
PBD 13	1	250 A	40 kA	screw terminals		3 x 32 W	120 mm ²	1140	63-820995-011
PBD 13-1V	1	250 A	40 kA	Screw terminal, V-shaped terminal	 	3 x 32 W	120 mm ²	1120	63-820995-021
PBD 13-2V	1	250 A	40 kA	V-shaped terminals		3 x 32 W	120 mm ²	1140	63-820995-031

PBD fuse bases are made of self extinguishing, fibre glass strenghtened polyester.

Delivered with set of:

- screws for screw terminals
- insulation barriers
- for 3 - pole fuse bases e.g. PBD 003, PBD13

PBD fuse base size	Tightening torque (Nm)	
		
00 \ 003	10	20
1	32	30
2	32	30
3	56	30

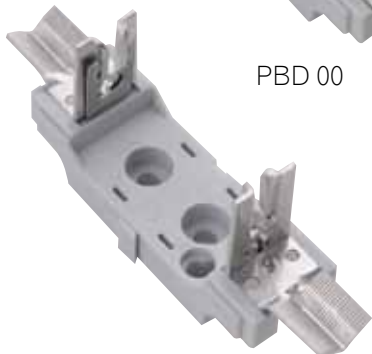


DIMENSIONS OF PBD FUSE BASES

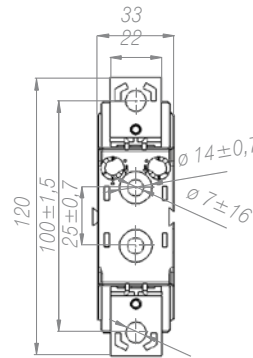
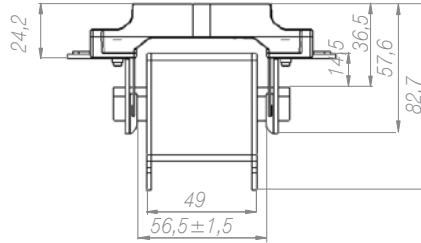
PBD FUSE BASES OF SIZE 00 - 1 - POLE



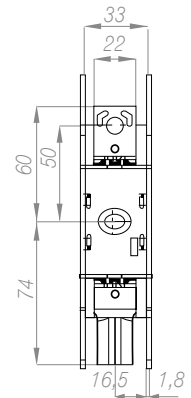
PBD 00



PBD 00-2V

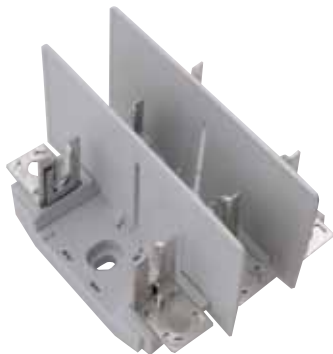


PBD 00



PBD 00-1V

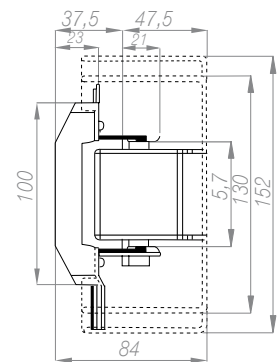
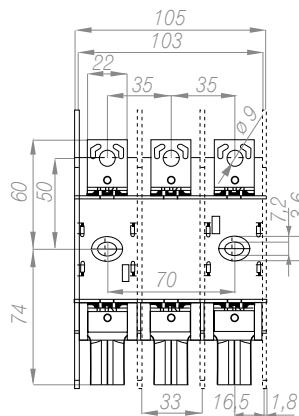
PBD FUSE BASES OF SIZE 00 - 3 - POLE



PBD 003 HH

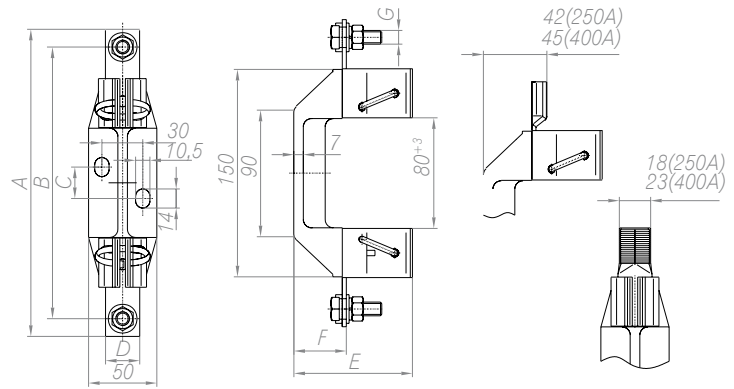


PBD 003 VV



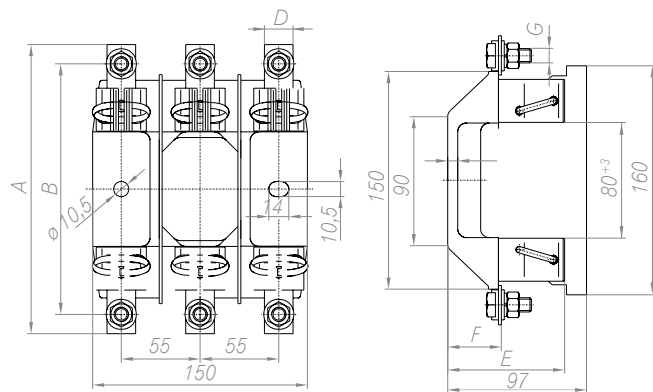
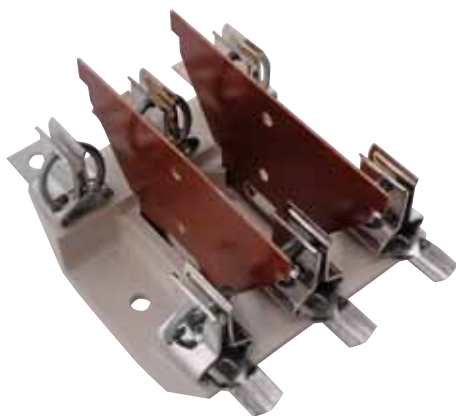
PBD 003-1V

PBD FUSE BASES OF SIZE 1,2,3 - 1- POLE



Article	Dimension [mm]						
	A	B	C	D	E	F	G
PBD 1	200	175	23	25	82	37	M10
PBD 1-1V	200	-	23	25	82	37	M10
PBD 1-2V	200	-	23	-	82	-	-
PBD 2	225	200	23	25	88	38	M10
PBD 2-1V	225	-	23	25	88	38	M10
PBD 2-2V	225	-	23	-	88	-	-
PBD 3	240	210	23	40	95	39	M12

PBD FUSE BASES OF SIZE 1,2,3 - 3- POLE



Article	Dimension [mm]						
	A	B	C	D	E	F	G
PBD 13	200	175	-	-	82	37	M10
PBD 13-1V	-	-	-	-	82	37	M10
PBD 13-2V	-	-	-	-	82	-	-

ACCESORIES FOR PBD FUSE BASES

V-TERMINAL CLAMPS, HS V-TERMINAL CLAMPS (STEEL)

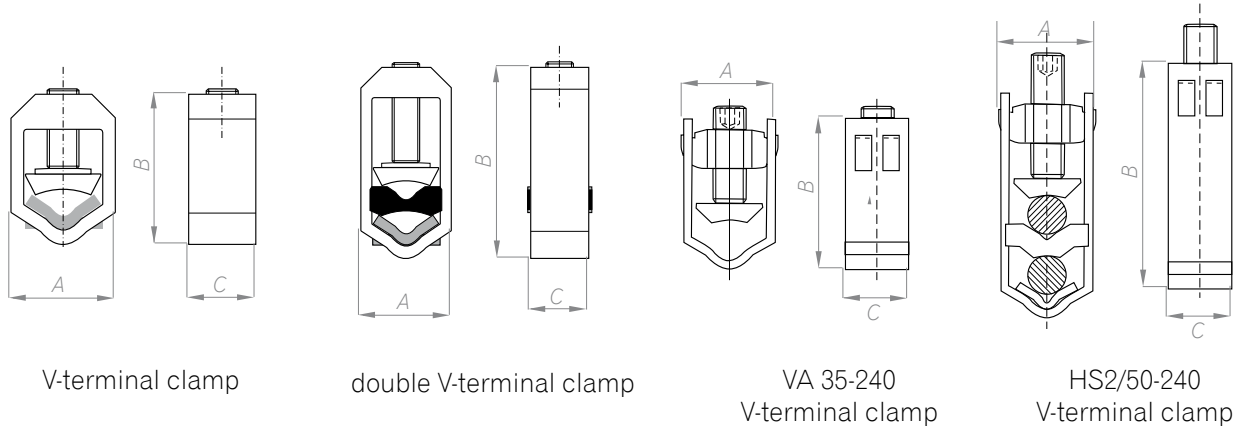





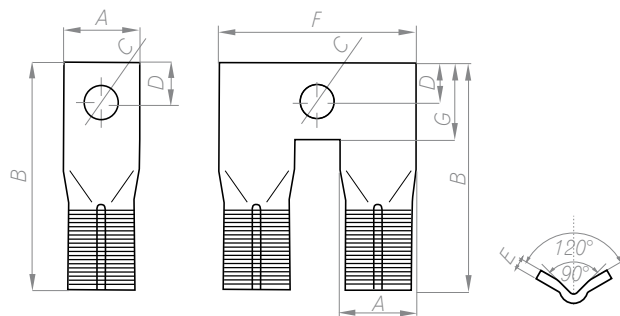
Table 65. V-TERMINAL CLAMPS

	Article	Cross section of cable conductor [mm ²]				Dimension [mm]			Tightening torque	Material	Weight [g]	Article No.
		re 	se 	rm 	sm 	szer. [A]	wys. [B]	gf. [C]				
	25-120SW	16÷95	25÷120	16÷95	25÷120	28	38	18,5	30 Nm	alu.	48	1119510008T
	2/25-120SW	16÷95	25÷120	16÷95	25÷120	27,5	58	18,5	30 Nm	alu.	87	1119510006T
	50-240SW	35÷120	50÷240	35÷95	50÷185	35	49	23	30 Nm	alu.	90	1119510001T
	2/50-240SW	35÷150	50÷240	35÷120	50÷185	37	76	23	30 Nm	alu.	177	1119510007T
	70-300SW	70÷150	95÷300	50÷120	70÷240	35	49	23	30 Nm	alu.	95	1119510013T
	2/70-300SW	70÷150	95÷300	50÷120	70÷240	37	76	23	30 Nm	alu.	183	1119510014T
	VA 35-240	35÷240	50÷240	35÷185	50÷240	33	63	25	40 Nm	stal		1119510052
	HS2/50-240	35÷185	50÷240	35÷150	50÷185	35	81	23	40 Nm	stal	228	1119510016T

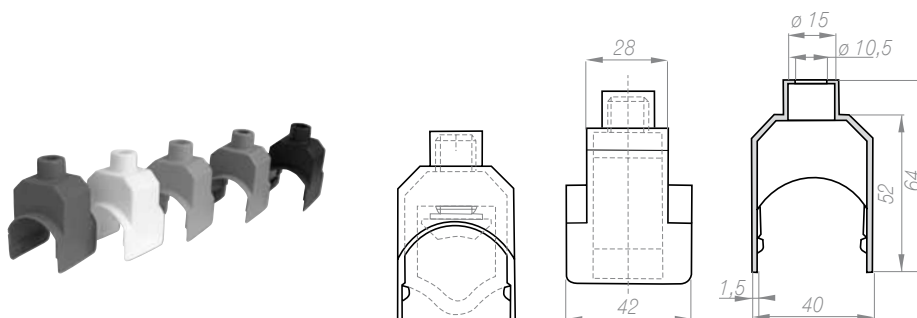
Table 66. V-SHAPED TERMINAL LUGS

	Article	Dimension [mm]							Material	Weight [g]	Article No.
		A	B	C	D	E	F	G			
	V-shaped terminal lug VL120	20	65	10,5	10	3	-	-	Cu	32	1119510005T
	V-shaped terminal lug VL240	25	75	13	11,5	5	-	-	Cu	75	1119510002T
	double Vshaped terminal lug C	25	75	10,7	12,5	3	65	25	Cu	107	1119510028T

SHROUDS FOR V-TERMINAL CLAMPS



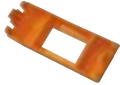





Shrouds for V-terminal clamps 50-240SW, 70-300SW Available in colours: white, black, red, grey

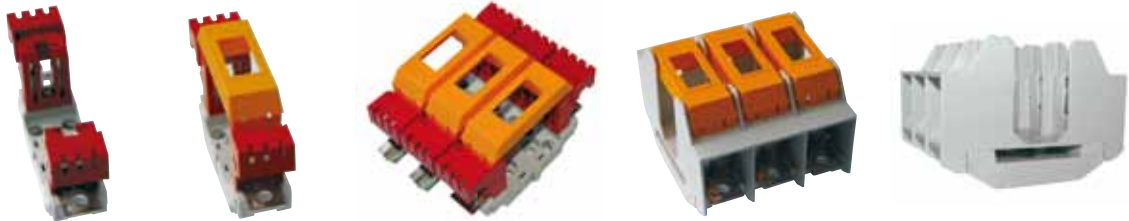


1119510018T-blue, 1119510019T-red, 1119510026T-black,
1119510044T-yellow, 1119510045Tgreen



Table 67. PBD 00 ACCESORIES

Picture of Article	Article	Article No.
	Fuse-link shroud, Sicherungseinsatz- Abdeckung	1115281078T
	Short shroud for contact and screw terminal, Kontakt-Kurzabdeckung, Schrauben	1115281076T
	Long shroud for contact and Vterminal clamp Kontakt-Langabdeckung und VKlemme	1115281077T
	Shroud for 3-pole, size 00 fuse base with screw terminals Abdeckung für 3-Pol Unterteil Gr.00 mit Schrauben	1115281079T
	Short insulation barrier for 3-pole fuse base with screw terminals	1115281075T
	Long insulation barrier for 3-pole fuse base with V-shaped terminals	1115281074T

EXAMPLES OF APPLICATION

UNIVERSAL EARTHING DEVICE UU00-3

Universal earthing device UU00-3 is a portable device for temporary short-circuiting and earthing three phase AC low voltage circuit. Universal earthing device UU00-3 is designed for earthing of solidly earthed neutral three phase systems or indirectly earthed neutral three phase systems. It is designed for mounting in place of fuse-links or for fixing to termination points with M10 thread. Universal earthing device is designed for use with PBD fuse bases of all sizes (00 - 3).
Article No. : 1115281041T.



DESCRIPTION

1. short-circuiting links
2. working pole
3. earth terminal
4. short-circuiting cable
5. earthing cable
6. cable connection point
7. case

PRESSED NUTS

Available in sizes: M8, M10, M12

Article No. :

- M8 (for hole with diameter 10 H11) 0653518082T
- M10 (for hole with diameter 12,5 H11) 0653518084T
- M12 (for hole with diameter 14,5 H11) 0653518083T

